

GT

GT Series Pneumatic Gear Vibrator



● Product Features:

Vibration intensity can be adjusted based on air pressure, can immediately start, stop, fast, low-noise, vibration force, security.

● Application:

Feed material conveyor, vibrating screening, vibrating hopper, to help fill packaging, foundry sand mold vibration.

● Works

Copper eccentric gear installed counterweight impact at intake charge into the gear thrust gear rotates, the eccentric rotation of the centrifugal weight with vibration, the gear driven by a bearing, low noise.

● Technical parameters

Type	Frequency(V.P.M)			Vibration power(N)			Air consumption(/min)		
	0.2Mpa	0.4Mpa	0.6Mpa	0.2Mpa	0.4Mpa	0.6Mpa	0.2Mpa	0.4Mpa	0.6Mpa
GT-4	11.500	12.500	13.500	130	165	210	30	40	50
GT-6	11.500	12.500	13.500	130	165	210	30	40	50
GT-8	34.850	42.000	45.500	980	2.100	2.800	46	80	112
GT-10	27.500	35.000	37.500	840	1.390	2.400	46	80	112
GT-13	26.000	30.000	33.000	1.400	2.440	3.730	120	200	290
GT-16	17.000	21.500	24.000	1.220	2.090	3.160	120	200	290
GT-20	17.000	20.000	23.000	2.170	4.040	5.520	185	325	455
GT-25	12.000	15.500	17.000	2.120	3.510	5.070	185	325	455
GT-32	13.000	14.000	16.000	3.380	5.430	7.540	330	530	745
GT-36	7.800	10.000	13.000	3.300	5.000	7.150	330	530	745
GT-40	7.500	8.800	9.500	4.350	7.350	9.850	408	428	680
GT-48	5.800	7.500	9.700	4.950	7.750	10.6007	408	428	680
GT-60	4.758	6.530	8.515	5.700	9.800	11.150	505	600	920

● Overall Dimension

(mm)

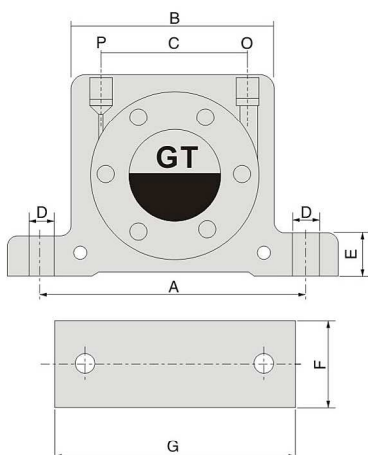

Type	A	B	C	D	E	F	G	P/O	Weight(g)
GT-4	56	40	20	6	10	28	70	1/8	280
GT-6	56	40	20	6	10	28	70	1/8	280
GT-8	68	50	28	7	12	35	86	1/8	280
GT-10	68	50	28	7	12	35	86	1/8	280
GT-13	90	65	39	9	16	43	113	1/4	610
GT-16	90	65	39	9	16	43	113	1/4	610
GT-20	104	82	56	9	17	56	128	1/4	1120
GT-25	104	82	56	9	17	56	128	1/4	1120
GT-32	130	103	76	11	21	73	160	3/8	2150
GT-36	130	103	76	11	21	73	160	3/8	2150
GT-40	152	122	85	18	27	80	194	3/8	3530
GT-48	152	122	85	18	27	80	194	3/8	3530
GT-60	195	140	96	21	30	95	240	1/2	5590